

OUR LEVEL BEST.



Liquid Level Control by

AWE

Liquid Level Control

Liquid Level Controllers



ALC1101

Liquid Level Controller

- ★ Dual Voltage Supply 110/240v
- ★ LED Indication of Mains supply
- ★ Fail to Safe Fill or Empty
- ★ Adjustable Sensitivity
- ★ LED Indication of Relay State
- ★ Plug in Mounting.
- ★ Optional IP55 Housing

The Model **ALC1101 Liquid Level Controller** is a compact, panel-mounted solution designed for dependable monitoring and control of conductive liquid levels. Built with robust electronics and a user-friendly interface, it delivers efficient and accurate liquid level management across a wide range of applications.

This controller operates by sensing electrical resistance between electrodes positioned at user-defined levels. These electrodes connect to a low-voltage sensing circuit, which activates an internal switching relay when the liquid level makes or breaks contact. Visual indicators on the front panel show operating status—a green LED for power and a red LED for relay activation.

Whether you're managing a high or low level alarm or controlling between two levels for pumping in or out, the ALC1101 adapts seamlessly via a simple function switch.

The unit requires:

- 2 electrodes (alarm level + earth return) for alarm mode
- 3 electrodes (2 levels + earth return) for fill/drain control mode

With its straightforward design, durable construction, and flexible functionality, the ALC1101 provides years of reliable service in industrial and commercial fluid handling systems.

Key Features:

- Panel-mounted for easy installation
- Visual LED indicators for power and relay status
- Selectable alarm or pump control modes
- Works with AWE conductive level electrodes
- Simple, long-lasting design for dependable performance

Ideal for sumps, tanks, process vessels, and anywhere conductive liquid level control is essential.

Level Alarm

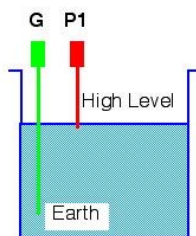

High Level Alarm

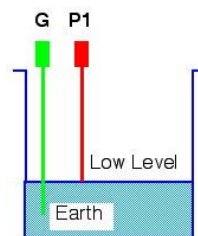

Low Level Alarm

Level Control

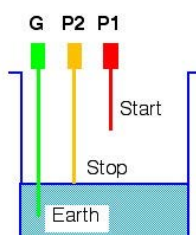

Pumping Out Between Two Levels

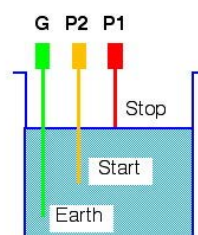

Pumping In Between Two Levels

Liquid Level Control

Conductivity Level Electrodes

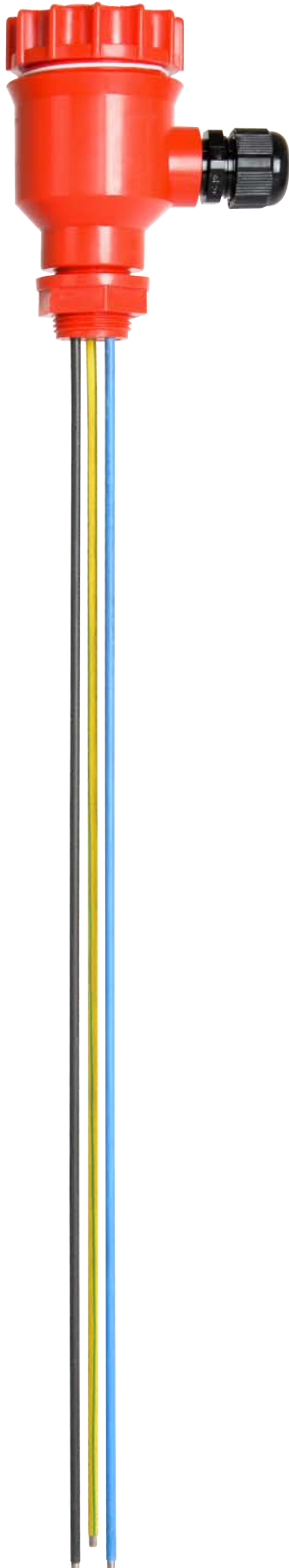

LE24

Liquid Level Electrode

- * Use with ALC1101 Controller
- * Electrode in 316 Stainless Steel
- * Option for other Materials
- * Length 900 mm Cut to Length
- * Corrosion Resistant PP Housing
- * IP65 Weatherproof for outside use
- * Simple to use and Install
- * Mounting bracket available
- * Manufactured in the UK

The **LE24 Level Electrode System** is a compact and reliable solution for liquid level control in industrial and process applications. Designed for use with the AWE Instruments ALC1101 Level Controller, it offers precise monitoring and control of pump contactors, solenoid valves, or alarms for filling or emptying tanks and vessels. Key Features include:

- **Three 900 mm Electrodes**

Supplied with 3 x 316 stainless steel electrodes, each PVC insulated to prevent electrical tracking in damp or humid environments.

- **Durable Construction**

The electrode housing is moulded in robust polypropylene for chemical resistance and long service life.

- **Factory-Potted Terminals**

Electrodes are permanently potted and connected to clearly labelled terminals for straightforward installation.

System Applications:

Automatic Level Control

Requires three electrodes:

- Start electrode (pump or fill start)
- Stop electrode (pump or fill stop)
- Earth return electrode

High/Low Level Alarms

- High electrode activates the alarm
- Low electrode resets the alarm
- Earth electrode required for circuit completion

Note: A single earth (reference) electrode may be shared across multiple control systems. However, electrodes should not be used for dual purposes—dedicated electrodes are recommended for each function to ensure reliable operation.

Liquid Level Control

Conductivity Level Electrodes



LE7

Liquid Level Electrode

- * **Manufactured in the UK**
- * **Simple to use and Install**
- * **For use with ALC1101 Controller**
- * **Electrode in 316 Stainless Steel**
- * **Choice of Electrode Materials**
- * **Standard Length up to 3m long**
- * **Couplings & Steady Brackets Option**
- * **Housing in Corrosion Resistant PP**
- * **IP65 Weatherproof for Outside Use**
- * **Optional Surface Mounting Brackets**



The **LE7 level electrode holder** is a compact and durable solution, ideal for single-point level sensing or automatic level control in a wide range of industrial applications. Designed to hold one 6 mm diameter electrode as standard, it can also be adapted to hold 1/4" or 8 mm diameter electrodes by special order.

Built for seamless integration with the ALC1101 level controller, the LE7 enables reliable liquid level monitoring and control through flexible electrode configurations:

Typical Applications:

- High or Low-Level Alarm

Requires 2 electrodes

- Latching High or Low-Level Alarm

Requires 3 electrodes (including reset functionality)

- Fully Automatic Control Between Two Levels

Requires 3 electrodes: Start, Stop, and Earth Return, A switch on the ALC1101 controller selects between fill or empty operations

Electrode Options:

- 316 Stainless Steel – Up to 3 metres in length
- Titanium or Hastelloy – Up to 2 metres

Coating Option:

- PPA plastic-coated electrodes to reduce tracking between electrodes

For applications deeper than 3 metres, we offer threaded electrodes designed for use with extension connectors and steady brackets, ensuring secure installation and extended reach.

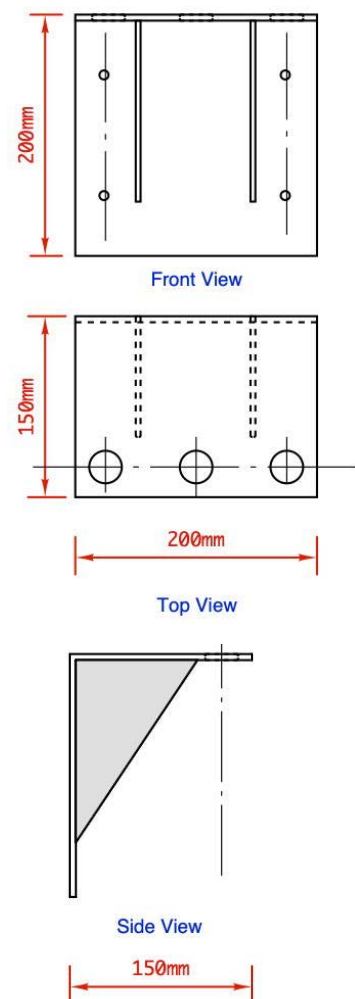
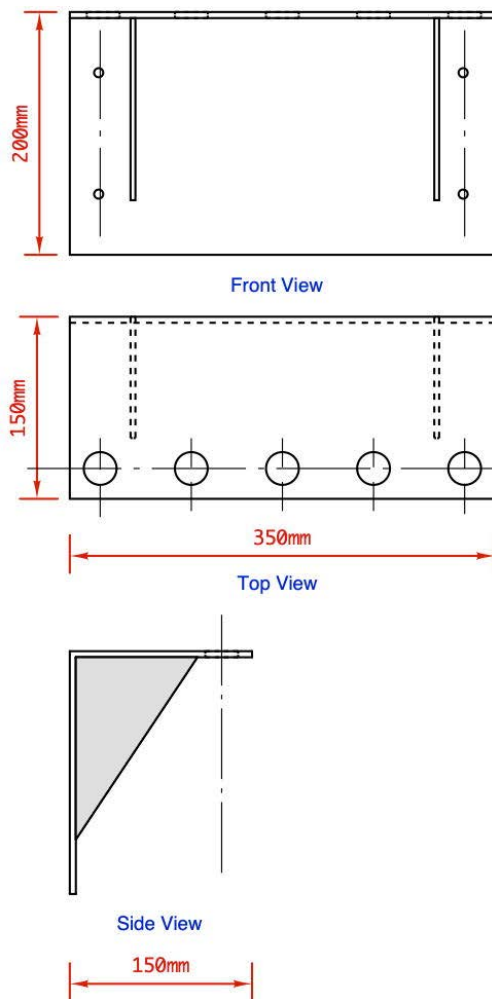

For installation in deep pits and sumps, we offer mounting brackets designed to hold between one and five LE7 electrodes. These brackets are made from black UV- and chemical-resistant polypropylene, providing a robust, non-conductive solution. To ensure stability, we also supply matching steady brackets that can be positioned lower down in the pit or sump, aligned with the main mounting bracket, to minimise electrode movement during filling.

Our standard electrodes are 3 metres long and manufactured from 316 stainless steel. For greater depths, we can provide threaded electrodes with stainless steel couplings. When using coated electrodes, these couplings must be insulated to prevent premature activation of the level controller before the exposed stainless steel tip is reached.

Multiple steady brackets can be used to support very long electrodes where required.

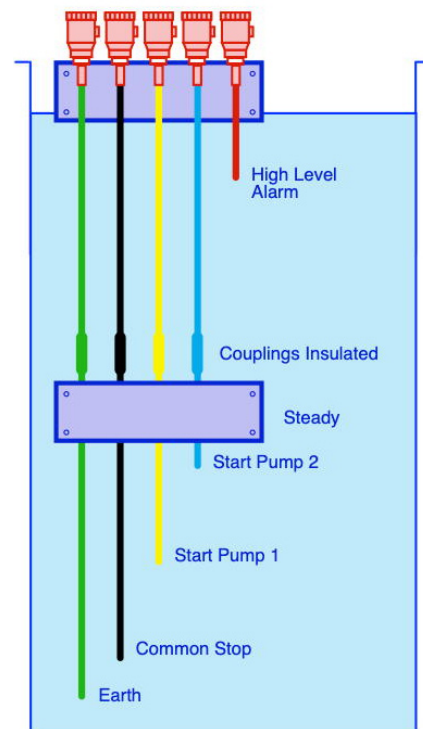

Pumping out of a deep sump using duty and assist pumps with high level alarm requires 3 x ALC1101

LE10-5 & LE8 Liquid Level Electrode

- * **Housing in Corrosion Resistant PVC**
- * **Choice of Electrode Materials**
- * **Length up to 3m long Stainless Steel**
- * **Designed to IP65 for Outside Use**

For applications where installation space is limited, the **LE8 and LE10 multi-electrode holders** offer a reliable and adaptable solution for level sensing in challenging environments.

LE8 Electrode Holder

Designed for compact installations, the LE8 accommodates 2 to 5 stainless steel electrodes, each 6 mm in diameter and available in lengths up to 3 metres. To minimise electrical tracking between electrodes, coatings are recommended.

For chemically aggressive applications, titanium or Hastelloy electrodes with PTFE insulation are available, typically in 2 metre lengths. Mounting options for the LE8 include:

- 1½" BSP male thread
- PVC mounting flange
- PVC quick-release fitting

LE10 Electrode Holder

Engineered for municipal water treatment and larger installations, the LE10 supports 2 to 5 electrodes of 8 mm diameter. It features a 2" BSP male thread, with options for a mounting flange or quick-release fitting.

Cable entry is via a 20 mm female thread for use with 20 mm cable glands and SWA or SY cables, allowing robust side-entry wiring.

Accessories & Customisation

Both the LE8 and LE10 systems can be supplied with:

- Polypropylene mounting brackets
- Steady brackets
- Spacers
- Stainless steel couplings for electrode extension and support

Standard holders are designed for drop-in electrodes, but sealed, coated, and cut-to-length electrodes can be supplied to suit your application. These holders are ideal for integration with level control systems such as the ALC1101.

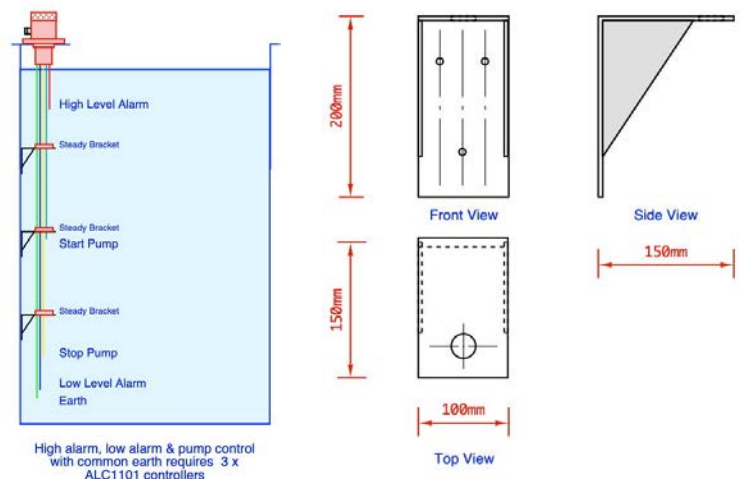
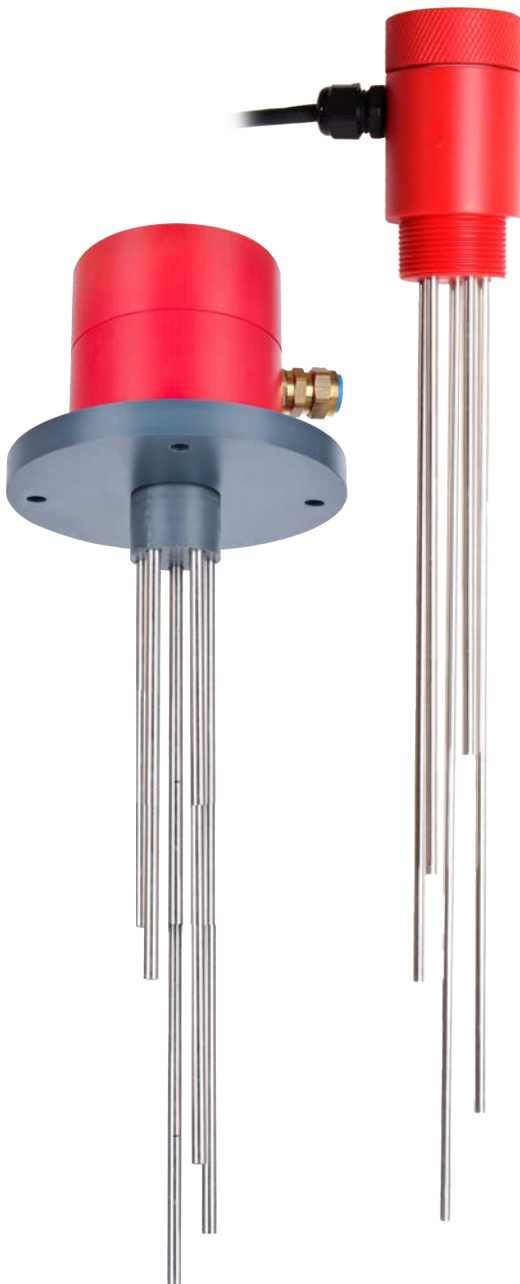

LE10-1

Heavy Duty Liquid Level Electrode

- ★ **Housing in Corrosion Resistant PVC**
- ★ **Choice of Electrode Materials**
- ★ **Length up to 3m long Stainless Steel**
- ★ **Designed to IP65 for Outside Use**



The **LE10-1 level electrode holder** has been engineered for reliable performance in harsh environments such as wastewater sumps, sewage tanks, and industrial effluent systems. Designed to hold a 3/4" pipe electrode (26.7 mm diameter, 2.87 mm wall thickness), the unit includes a sealed 3/4" cap to prevent condensation ingress into the housing. Key features include:

- **Durable Construction**

Built for demanding applications including sewage, trade effluent, and chemically aggressive liquids.

- **Flexible Electrode Options**

Supplied with 3.0 metre long 316 stainless steel threaded electrodes. For deeper installations, threaded electrodes with stainless steel couplings and steady brackets are available.

- **Corrosion Resistance**

Optional electrodes in titanium or Hastelloy provide excellent resistance in corrosive environments.

- **PPA Coated Electrodes**

PPA plastic coatings are available, including WRAS-approved options suitable for drinking water applications.

System Integration

Fully compatible with the AWE Instruments ALC1101 level controller for a variety of control schemes:

- High- or Low-Level Alarms with reset and earth electrodes
- Pump Control Between Levels using a selector switch for fail-safe fill or empty modes

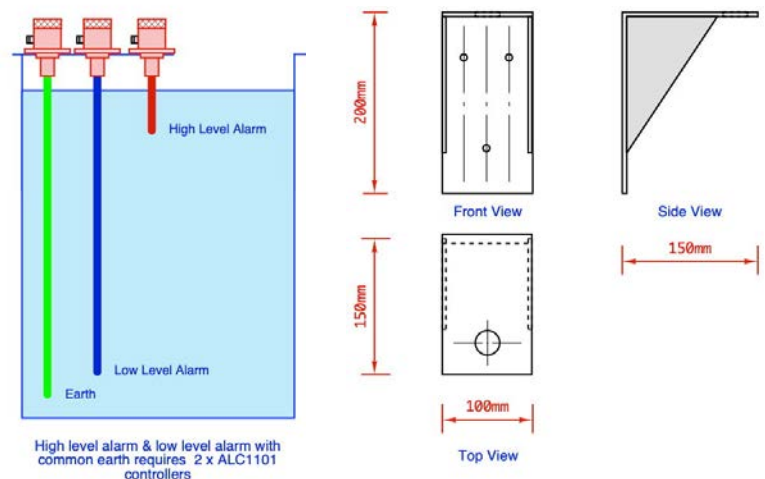

Problem Solvers

Level Electrodes for concentrated chemical reagents



For Water Treatment, Wastewater & Process Applications
We offer a comprehensive range of robust and reliable level control systems engineered to perform in demanding environments, including concentrated reagents and complex chemical mixtures.

LE6 Electrode Systems

- Models: LE6/3 (3 electrodes) & LE6/5 (5 electrodes)
- PVC tube with special seal and conductive tips
- Supplied with 2" flange or quick-release fittings
- Electrodes can be cut to length for flexible installation
- Cost-effective solution for reagent storage and process tanks

LPS1 Pneumatic Level Switch

- Safe, reliable, no liquid contact design
- PVDF body with Viton diaphragm and seals
- Operates at very low pressure (just millimetres of water gauge)
- Easy 3/4" BSP mounting with dip tube cut to required level
- Ideal for: demineralised water, foaming solutions, acids, hypochlorites, sludges & slurries
- Flange-mounted version available for deeper vessels
- Fails safe at low levels to protect heated tanks

Float Switches

- Built in engineered plastics or 316 stainless steel
- Adjustable mounting with BSP boss or PVC flange
- Suitable for RO water, acids, alkalis, hot demin water
- Made to order with custom lengths up to 2 metres
- Reliable and simple level control for non-viscous solutions

Why Choose Our Systems?

- ✓ Durable materials (PVC, PP, PVDF, Stainless Steel)
- ✓ Flexible configurations to suit your process
- ✓ Easy installation & maintenance
- ✓ Safe and proven operation in harsh environments

AWE

Automated Water & Effluent Ltd, AWE House, Antom Court,
Tollgate Industrial Estate, Stafford, ST16 3AF

Telephone: 01785 254 597 Email: sales@awe-ltd.co.uk